

Flip Hose Automatic Pool Cleaner (and Sprays) Installation & Operating Instructions

(1) Automatic Pool Cleaning - Flip Hose and Sprays

What is a Flip Hose?

The flip hose is the working part of an automatic pool cleaning system that is built into your pool and is designed to maintain your pool sparkling clean.

How Does It Work?

Each flip hose consists of a long flexible tube with sliders spaced along it and it has a nozzle at the end. Filtered pool return water is diverted through hoses to provide a powerful water jet to sweep the hose over the pool floor in random motion. The water jetstream dislodges dust and sediment from the pool floor and with the sweeping action combines to keep all particles in suspension. The filter will then remove this matter under its normal operating cycle. The hoses will concentrate the larger particles - waterlogged twigs, leaves, etc., from where they may be easily removed by leaf rake.

Operating Costs

The system has no additional running costs as it utilizes the existing pumping equipment and uses the filtered pool return water for its entire operation. The hose cleans continuously whilst the pool filter is operating.

Other Advantages:

The flip hoses distribute the pool return water evenly over the entire floor of the pool. This provides superior mixing of pool chemicals and helps prevent algae formation.

When a pool heater is fitted, the flip hose is the most effective system of distributing heated water over the entire floor area of the pool, thus minimising stratification of heated water layers at the surface of the pool.

The flip hoses are easily disconnected and the spray system fitted. The graceful arc of each spray adds beauty to your pool setting and provides the peaceful, relaxing sounds of falling water.

(2) Installation:

The flip hose supply piping should be fitted to the pool during construction, preferably before the concrete is poured.

Run a 25mm min diameter supply pipe circuit around the inside of the pool and connect with 15mm PVC (class PE) pipe flush with the pool wall. The snap fitting receptor is then glued into this pipe. Run a 32mm min. diameter separate supply line from this circuit to connect through a gate valve at the filter. See diagrams 1, 2, 3.

It is recommended that 8-10 hoses be installed in the average size pool. Outlets must never be positioned in the corner and should at least 1.2 metres away from corners and steps.

For a 9 x 4.5 metre pool, place one outlet in each end, and four outlets along each side spaced at 1.5 - 2.5 - 2 - 2.5 - 1.5 metre intervals. See diagram 1.

It is not recommended that supply pipe be installed unsupported outside the pool shell as earth movement will cause breakages. The supply circuit should be cast integral with before coping tile or final finish is applied. See diagram 2 & 3.

(3) Flip Hose Operation and Maintenance:

To Fit The Flip Hose

Remove hoses from carton being careful not to tangle and connect as indicated in Diagram 4.

Correct Operating Pressure:

This will vary for each pool and the owner must adjust for his pool. To bring up pressure, fully open Flip Hose supply valve and close down RTP valve until hoses begin to move.

Correct operating pressure is reached when the hoses lazily sweep the pool floor and do not tangle or lay against the side of the pool.

It is very important that sliders are in good condition as these must wear to protect the hose (refer section 5)

Examine hoses and sliders regularly for uneven wear and replace sliders as required.

Some tips:

- (a) To protect hose, position sliders over worn spots.
- (b) To change wear patterns, connect hoses to different outlets around the pool.
- (c) Sweep patterns can be varied by using different spacings of the sliders.

(4) Removal From Pool and Storage:

The successful operation of the hoses depends upon the flexibility and perfect circularity of the tube. So the hoses must be handled with care and stored properly when not in use.

To Remove From the Pool

- (a) Fully open the RTP valve and close down the Flip Hose supply valve.
- (b) Disconnect the snap fittings following instructions in (diagram 4) withdraw each hose from the pool and lay straight out alongside the pool. Repeat for all hoses.
- (c) Gather one end of the hoses together and coil loosely in 610mm diameter circles. Make sure none of the hoses become kinked or twisted.

Storage of Hoses:

Lay the hoses flat on a smooth surface, in a shaded spot.

Donot leave the hoses coiled in sunlight, and never hang hoses on any form of hook or nail. This results in a permanent set in the tube which will seriously impair the whipping action.

To fit Sprays:

Install the spray fittings with the spray nozzle up and adjust the pressures as desired.

(5) Sliders and Nozzles:

The purpose of the nylon sliders is to:

- (a) Reduce wear on the hose.
- (b) Minimise friction between hoses and floor.
- (c) Control the whipping action.

It is therefore important to have the sliders correctly spaced and in good condition.

(Diagram 5) shows the spacing to suit most operating conditions, however the owner may need to vary this spacing to suit his pool.

To Remove Nozzle:

Pull the nozzle slider back from the end and gently prise the nozzle out of the end of the tube. (see diagram 6). To replace, reverse this procedure.

To Replace Sliders:

Remove the nozzle. This allows any slider to be removed. If it is difficult to remove sliders, slightly stretch the hose and move sliders whilst hose is under tension.

To fit the sliders, trim the flip hose to a point (as shown in diagram 7). This allows threading of the sliders on to the hose. Hose must be trimmed square to replace the nozzle.

To Shorten the Hose:

Remove nozzle, cut off 30cm length, replace nozzle and test the hose for satisfactory operation.

TROUBLESHOOTING GUIDE	
One or more flip hoses is kinked and will not operate correctly.	Hoses have permanent "set" from improper handling and storage. To straighten hoses, stretch firmly between two people in a tug-of-war-like fashion and lay straight out in the sun for several hours.
Flip Hoses lay against pool wall.	(a) Run hoses faster. (b) Hoses may be too long. Shorten 30cm at a time from the nozzle end.
One hose operates slower than the other hoses.	(a) Check for blocked nozzle. (b) Hose may be damaged or worn (replace).
Hose operates very slowly.	(a) Filter requires backwash. Check pump pressure for satisfactory operation of filtering system. (b) Supply hose maybe blocked with debris.
Flip hoses slow down after several days operation.	This is normal as the filter collects the sediment and requires a backwash. NOTE: For exceptionally dirty pools this may happen after a few hours operation.
Worn Sliders.	Sliders wear under normal operation. To protect the flip hose - replace sliders.
Flip hoses concentrate water-logged leaves and debris in small areas.	This is normal. Hoses concentrate these particles for easy removal be leaf rake.
When hoses are operating pressure gauge shows higher pressure.	This is normal.
Snap in connectors difficult to remove.	Check for debris in fitting "O" Ring may need lubrication with vaseline.
Dust collects on steps.	Flip hose will not clean steps - use pool broom.

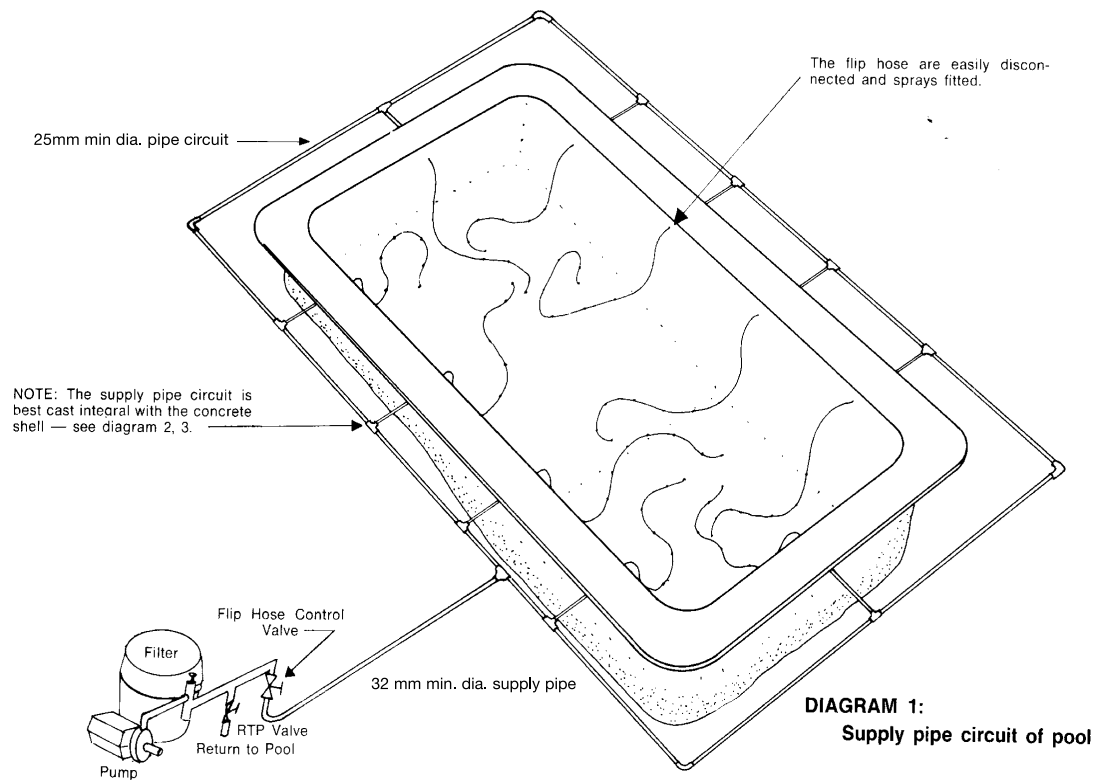

DIAGRAM 1:
Supply pipe circuit of pool

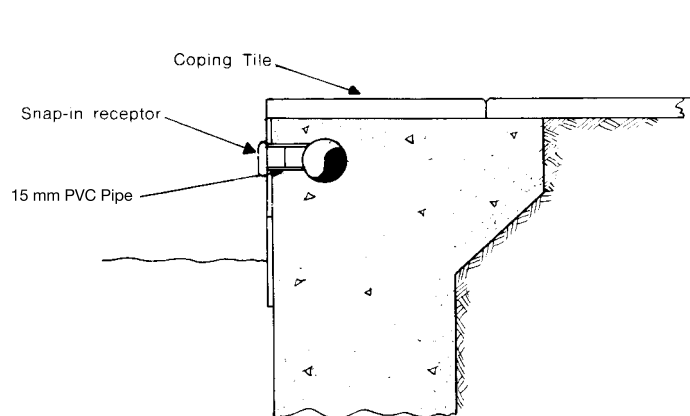

DIAGRAM 1: Installation in top of Pool Shell

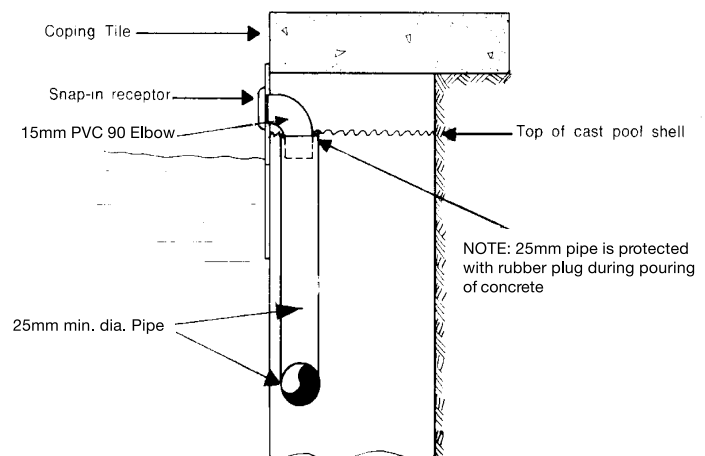

DIAGRAM 3: Installation inside Pool Wall

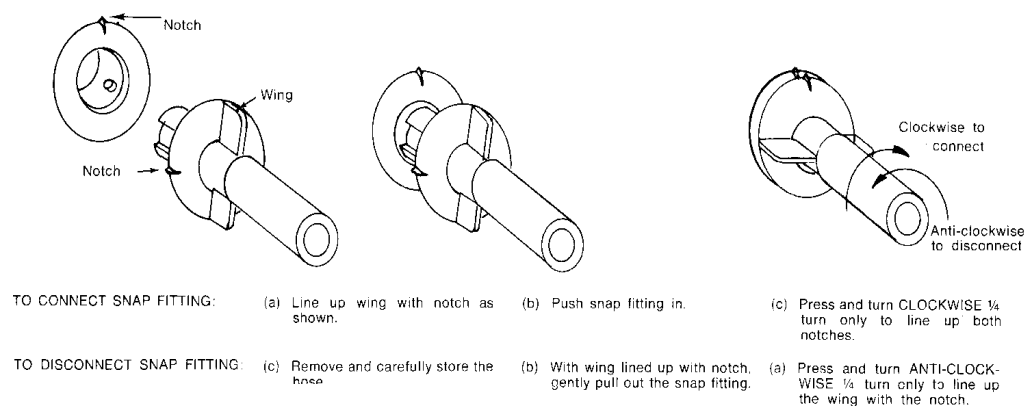

DIAGRAM 4: Connection of the Snap Fitting

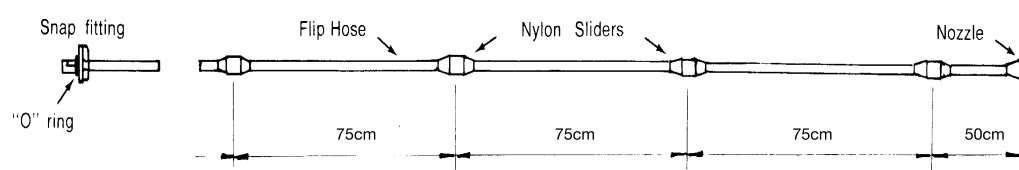

DIAGRAM 5: Correct Spacing of the Sliders

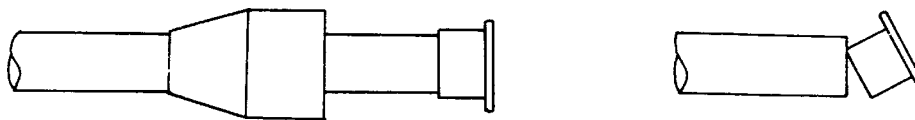

DIAGRAM 6 To remove nozzle, pull nozzle slider back — prize nozzle out

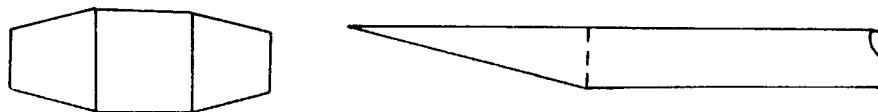

DIAGRAM 7 To fit slider, trim hose to a point and thread slider on

IMPORTANT

Please attach your sales invoice/docket here as proof of purchase should warranty service be required.

Please do not return Warranty Form to Pentair Australia - please retain for your records.

Purchased From

Purchase Date..... Serial No..... Model No.....



Head Office

Pentair AU/NZ: 1-21 Monash Drive,
Dandenong South, Vic 3175

Australia

National Customer Service: Phone: 1300 137 344
Fax: 1800 006 688
National Dealer Locator: Phone: 1800 664 266
Email: au.sales@pentair.com
Web: www.pentair.com.au

New Zealand

National Customer Service: Phone: 0800 654 112
Fax: 0800 806 642
National Dealer Locator: Phone: 0800 664 269
Email: nz.sales@pentair.com
Web: www.pentair.co.nz

International Australia/New Zealand

Phone: +61 3 9709 5800
Fax: +61 3 9709 5888

© Information contained here-in remains the property of Pentair Water Pty Ltd. Any reproduction, display, publication, modification or distribution is strictly prohibited without the prior written permission of Pentair Water Pty Ltd.

Disclaimer: Every endeavour has been made to publish the correct details in this data sheet. No responsibility will be taken for errors, omissions or changes in product specifications. Pentair Water reserves the right to change specifications